

## 1. Dimensions

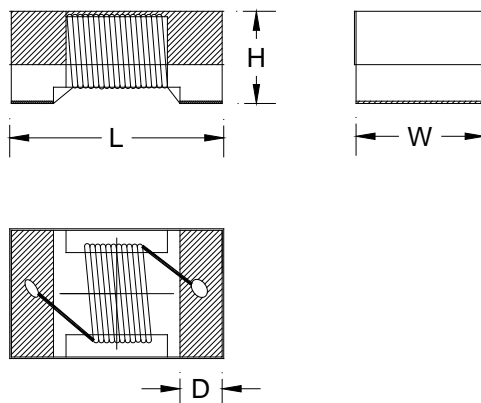

L	W	H	D
4.80 max.	3.40 max.	3.15 max.	0.65 typ.

## 2.Recommended Land Pattern

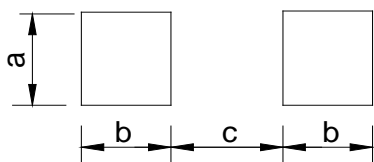

Symbol	Dimensions(mm)
a	3.05
b	1.14
c	3.00

## 2. Product Identification

KTW 1812 IF 1N0 □ S C

① ② ③ ④ ⑤ ⑥ ⑦

- ① Wire Wound Inductor Series;
- ② Dimensions: 1812(inch)=4532(mm)=4.5×3.2mm
- ③ Material: IF--- Ferrite core;
- ④ Inductance: 1N0=1.0nH、010=10nH、R10=100nH、1R0=1.0μH、100=10μH、101=100μH、102=1mH;
- ⑤ Tolerance: G---±2%; J---±5%; K---±10%;
- ⑥ Terminal: G--- Gold; S--- Tin;
- ⑦ Packaging type: C--- Tape& Reel.

All specifications are subject to change without notice.

### 3. Electrical Characteristics

Part Number	Accuracy grade	Inductance <sup>①</sup> (uH)	Inductance Test Conditions	Q value min.	Q value Test frequency (MHz)	DCR <sup>②</sup> (Ω)max.	Rated current <sup>③</sup> (mA)	SRF(MHz) min.
KTW1812IFR33□GC	J、K	0.33	25.2MHz/0.5V	10	25.2	0.13	1000	380
KTW1812IFR56□GC	J、K	0.56	25.2MHz/0.5V	10	25.2	0.15	1000	300
KTW1812IFR82□GC	J、K	0.82	25.2MHz/0.5V	10	25.2	0.20	1000	250
KTW1812IF1R0□GC	J、K	1.0	7.96MHz/0.5V	15	7.96	0.22	1000	200
KTW1812IF1R2□GC	J、K	1.2	7.96MHz/0.5V	15	7.96	0.35	1000	200
KTW1812IF1R5□GC	J、K	1.5	7.96MHz/0.5V	15	7.96	0.32	1000	180
KTW1812IF1R8□GC	J、K	1.8	7.96MHz/0.5V	15	7.96	0.35	950	160
KTW1812IF2R2□GC	J、K	2.2	7.96MHz/0.5V	15	7.96	0.37	900	150
KTW1812IF2R7□GC	J、K	2.7	7.96MHz/0.5V	15	7.96	0.37	850	145
KTW1812IF3R3□GC	J、K	3.3	7.96MHz/0.5V	15	7.96	0.48	800	140
KTW1812IF3R9□GC	J、K	3.9	7.96MHz/0.5V	15	7.96	0.60	750	135
KTW1812IF4R7□GC	J、K	4.7	7.96MHz/0.5V	15	7.96	1.00	700	120
KTW1812IF5R6□GC	J、K	5.6	7.96MHz/0.5V	15	7.96	0.55	650	110
KTW1812IF6R8□GC	J、K	6.8	7.96MHz/0.5V	15	7.96	0.80	600	80
KTW1812IF8R2□GC	J、K	8.2	7.96MHz/0.5V	10	7.96	0.85	600	70
KTW1812IF100□GC	J、K	10	2.52MHz/0.5V	10	2.52	1.00	550	65
KTW1812IF120□GC	J、K	12	2.52MHz/0.5V	10	2.52	1.10	550	55
KTW1812IF150□GC	J、K	15	2.52MHz/0.5V	10	2.52	1.20	500	35
KTW1812IF180□GC	J、K	18	2.52MHz/0.5V	10	2.52	1.20	500	29
KTW1812IF220□GC	J、K	22	2.52MHz/0.5V	10	2.52	1.30	450	20
KTW1812IF270□GC	J、K	27	2.52MHz/0.5V	10	2.52	1.50	400	20
KTW1812IF330□GC	J、K	33	2.52MHz/0.5V	10	2.52	1.70	350	18
KTW1812IF390□GC	J、K	39	2.52MHz/0.5V	10	2.52	1.80	350	14
KTW1812IF470□GC	J、K	47	2.52MHz/0.5V	10	2.52	2.00	300	10
KTW1812IF560□GC	J、K	56	2.52MHz/0.5V	10	2.52	2.20	290	10
KTW1812IF680□GC	J、K	68	2.52MHz/0.5V	10	2.52	2.40	260	5.4
KTW1812IF820□GC	J、K	82	2.52MHz/0.5V	10	2.52	2.80	240	5.2
KTW1812IF101□GC	J、K	100	0.796MHz/0.5V	10	0.796	3.00	220	4.0
KTW1812IF390□GC	J、K	120	0.796MHz/0.5V	10	0.796	3.30	220	3.3

All specifications are subject to change without notice.

# KTW1812IF Series

## Wire Wound Chip Inductors

Part Number	Accuracy grade	Inductance <sup>①</sup> (uH)	Inductance Test Conditions	Q value min.	Q value Test frequency (MHz)	DCR <sup>②</sup> (Ω)max.	Rated current <sup>③</sup> (mA)	SRF(MHz) min.
KTW1812IF151□GC	J、K	150	0.796MHz/0.5V	10	0.796	3.70	200	3.0
KTW1812IF181□GC	J、K	180	0.796MHz/0.5V	10	0.796	4.50	200	3.0
KTW1812IF221□GC	J、K	220	0.796MHz/0.5V	10	0.796	8.00	170	2.5
KTW1812IF271□GC	J、K	270	0.796MHz/0.5V	10	0.796	8.50	160	2.2
KTW1812IF331□GC	K	330	0.796MHz/0.5V	10	0.796	9.00	150	2.0
KTW1812IF391□GC	K	390	0.796MHz/0.5V	10	0.796	9.50	130	1.8
KTW1812IF471□GC	K	470	0.796MHz/0.5V	8	0.796	10.4	120	1.6
KTW1812IF561□GC	K	560	0.796MHz/0.5V	8	0.796	12.5	110	1.5
KTW1812IF681□GC	K	680	0.796MHz/0.5V	8	0.796	14.0	100	1.5
KTW1812IF751□GC	K	750	0.796MHz/0.5V	8	0.796	14.5	95	1.5
KTW1812IF821□GC	K	820	0.796MHz/0.5V	8	0.796	15.0	95	1.5
KTW1812IF102□GC	K	1000	0.252MHz/0.5V	6	0.252	16.5	90	1.4

- ① Inductance tested using an Agilent/HP4286A or equivalent.
- ② DCR measured on a micro-ohmmeter.
- ③ Rated current: The DC current at which the temperature rise  $\Delta t=40^{\circ}\text{C}$  ( $T_a=20^{\circ}\text{C}$ ).
- ④ □ Represents the tolerance of inductance: G ( $\pm 2\%$ ); J ( $\pm 5\%$ ); K ( $\pm 10\%$ ).

#### 4. Packaging Quantity: 2000 pcs per Reel.