

1. Dimensions

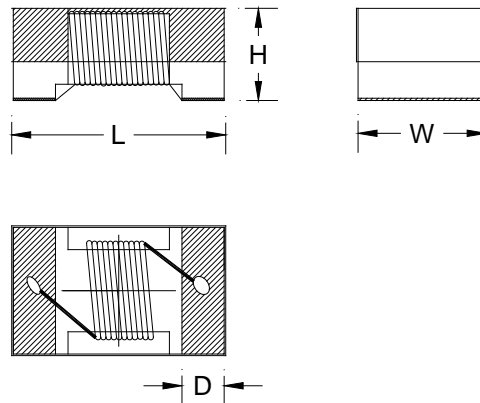

L	W	H	D
2.30 max.	1.70 max.	1.52 max.	0.50 typ.

2. Recommended Land Pattern

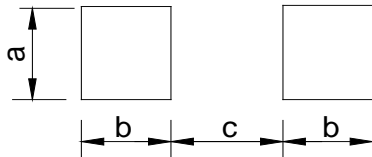

Symbol	Dimensions(mm)
a	1.78
b	1.02
c	0.76

2. Product Identification

KTW 0805 UF 1N0 □ S C

- ① Wire Wound Inductor Series;
- ② Dimensions: 0805(inch)=2012(mm)=2.0x1.2mm
- ③ Material: UF Ferrite core;
- ④ Inductance: 1N0=1.0nH、010=10nH、R10=100nH、1R0=1.0μH、100=10μH、101=100μH、102=1mH;
- ⑤ Tolerance: G---±2%; J---±5%; K---±10%;
- ⑥ Terminal: G--- Gold; S--- Tin;
- ⑦ Packaging type: C--- Tape& Reel.

3. Electrical Characteristics

Part Number	Accuracy grade	Inductance① (uH)	Inductance Test Conditions	Q value min.	Q value Test frequency (MHz)	DCR ② (Ω)max.	Rated current ③ (mA)	SRF(MHz) min.
KTW0805UFR33□GC	J、K	0.33	25.2MHz/0.5V	15	25.2	0.40	500	500
KTW0805UFR56□GC	J、K	0.56	25.2MHz/0.5V	10	25.2	0.40	450	500
KTW0805UFR68□GC	J、K	0.68	25.2MHz/0.5V	10	25.2	0.60	400	500
KTW0805UFR82□GC	J、K	0.82	25.2MHz/0.5V	10	25.2	0.80	400	500
KTW0805UF1R0□GC	J、K	1.0	7.96MHz/0.5V	10	7.96	1.00	360	430
KTW0805UF1R2□GC	J、K	1.2	7.96MHz/0.5V	10	7.96	1.15	350	410
KTW0805UF1R5□GC	J、K	1.5	7.96MHz/0.5V	10	7.96	1.20	300	400
KTW0805UF1R8□GC	J、K	1.8	7.96MHz/0.5V	10	7.96	1.35	200	380
KTW0805UF2R0□GC	J、K	2.0	7.96MHz/0.5V	12	7.96	1.45	200	350
KTW0805UF2R2□GC	J、K	2.2	7.96MHz/0.5V	10	7.96	1.50	170	350
KTW0805UF2R4□GC	J、K	2.4	7.96MHz/0.5V	10	7.96	1.60	145	330
KTW0805UF2R7□GC	J、K	2.7	7.96MHz/0.5V	10	7.96	1.70	100	320
KTW0805UF3R0□GC	J、K	3.0	7.96MHz/0.5V	10	7.96	1.80	100	300
KTW0805UF3R3□GC	J、K	3.3	7.96MHz/0.5V	10	7.96	1.80	90	300
KTW0805UF3R9□GC	J、K	3.9	7.96MHz/0.5V	10	7.96	1.95	90	280
KTW0805UF4R3□GC	J、K	4.3	7.96MHz/0.5V	10	7.96	2.00	85	270
KTW0805UF4R7□GC	J、K	4.7	7.96MHz/0.5V	10	7.96	2.05	85	250
KTW0805UF5R1□GC	J、K	5.1	7.96MHz/0.5V	10	7.96	2.20	60	240
KTW0805UF5R6□GC	J、K	5.6	7.96MHz/0.5V	10	7.96	2.30	70	240
KTW0805UF6R8□GC	J、K	6.8	7.96MHz/0.5V	10	7.96	2.60	55	220
KTW0805UF7R5□GC	J、K	7.5	7.96MHz/0.5V	10	7.96	2.80	55	210
KTW0805UF8R2□GC	J、K	8.2	7.96MHz/0.5V	10	7.96	3.00	50	180
KTW0805UF100□GC	J、K	10	2.52MHz/0.5V	8	2.52	3.20	30	150
KTW0805UF120□GC	J、K	12	2.52MHz/0.5V	8	2.52	3.50	17	110
KTW0805UF150□GC	J、K	15	2.52MHz/0.5V	8	2.52	4.20	16	100
KTW0805UF180□GC	J、K	18	2.52MHz/0.5V	8	2.52	4.50	15	95
KTW0805UF220□GC	J、K	22	2.52MHz/0.5V	8	2.52	6.00	14	80
KTW0805UF220□GC	J、K	22	2.52MHz/0.5V	8	2.52	6.00	14	80

① Inductance tested using an Agilent/HP4286A or equivalent.

② DCR measured on a micro-ohmmeter.

③ Rated current: The DC current at which the temperature rise $\Delta t=40^{\circ}\text{C}$ ($T_a=20^{\circ}\text{C}$).

④ □ Represents the tolerance of inductance: G ($\pm 2\%$); J ($\pm 5\%$); K ($\pm 10\%$).

4. Packaging Quantity: 3000 pcs per Reel.

All specifications are subject to change without notice.