

1. Dimensions

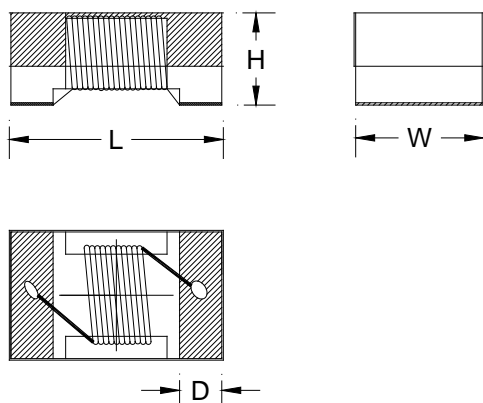

L	W	H	D
2.30 max.	1.70 max.	1.52 max.	0.50 typ.

2. Recommended Land Pattern

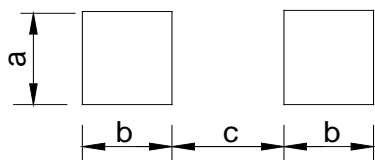

Symbol	Dimensions(mm)
a	1.78
b	1.02
c	0.76

2. Product Identification

KTW 0805 UC 1N0 □ S C

- ① Wire Wound Inductor Series;
- ② Dimensions: 0805(inch)=2012(mm)=2.0x1.2mm
- ③ Material: UC Ceramic core;
- ④ Inductance: 1N0=1.0nH、010=10nH、R10=100nH、1R0=1.0μH、100=10μH、101=100μH、102=1mH;
- ⑤ Tolerance: G---±2%; J---±5%; K---±10%;
- ⑥ Terminal: G--- Gold; S--- Tin;
- ⑦ Packaging type: C--- Tape& Reel.

3. Electrical Characteristics

Part Number	Accuracy grade	Inductance① (nH)	Inductance Test Conditions	Q value min.	Q value Test frequency (MHz)	DCR ② (Ω)max.	Rated current ③ (mA)	SRF(MHz) min.
KTW0805UC2N2□GC	K	2.2	250MHz/0.5V	50	1500	0.03	800	8500
KTW0805UC2N5□GC	J、K	2.5	250MHz/0.5V	40	1500	0.040	800	8000
KTW0805UC2N7□GC	G、J、K	2.7	250MHz/0.5V	50	1500	0.045	800	8000
KTW0805UC3N0□GC	J、K	3.0	250MHz/0.5V	35	1500	0.09	600	8000
KTW0805UC3N3□GC	K	3.3	250MHz/0.5V	35	1500	0.09	600	7900
KTW0805UC4N7□GC	K	4.7	250MHz/0.5V	40	1000	0.05	600	6000
KTW0805UC5N1□GC	G、J、K	5.1	250MHz/0.5V	50	1000	0.05	600	5800
KTW0805UC5N4□GC	G、J、K	5.4	250MHz/0.5V	50	1000	0.050	600	5800
KTW0805UC5N6□GC	G、J、K	5.6	250MHz/0.5V	50	1000	0.065	600	5500
KTW0805UC6N2□GC	G、J、K	6.2	250MHz/0.5V	50	1000	0.11	600	5500
KTW0805UC6N8□GC	G、J、K	6.8	250MHz/0.5V	50	1000	0.11	600	5500
KTW0805UC7N5□GC	G、J、K	7.5	250MHz/0.5V	35	1000	0.150	600	4700
KTW0805UC7N8□GC	G、J、K	7.8	250MHz/0.5V	35	1000	0.200	600	4700
KTW0805UC8N2□GC	G、J、K	8.2	250MHz/0.5V	35	1000	0.20	600	4700
KTW0805UC010□GC	G、J、K	10	250MHz/0.5V	50	500	0.15	600	4200
KTW0805UC011□GC	G、J、K	11	250MHz/0.5V	50	500	0.15	600	4000
KTW0805UC012□GC	G、J、K	12	250MHz/0.5V	50	500	0.15	600	4000
KTW0805UC014□GC	G、J、K	14	250MHz/0.5V	50	500	0.16	600	3500
KTW0805UC015□GC	G、J、K	15	250MHz/0.5V	45	500	0.17	600	3400
KTW0805UC016□GC	G、J、K	16	250MHz/0.5V	55	500	0.10	600	3400
KTW0805UC018□GC	G、J、K	18	250MHz/0.5V	55	500	0.20	600	3300
KTW0805UC020□GC	G、J、K	20	250MHz/0.5V	55	500	0.22	500	2800
KTW0805UC022□GC	G、J、K	22	250MHz/0.5V	55	500	0.22	500	2600
KTW0805UC024□GC	G、J、K	24	250MHz/0.5V	50	500	0.23	500	2500
KTW0805UC025□GC	G、J、K	25	250MHz/0.5V	50	500	0.24	500	2500
KTW0805UC027□GC	G、J、K	27	250MHz/0.5V	55	500	0.25	500	2500
KTW0805UC030□GC	G、J、K	30	250MHz/0.5V	55	500	0.26	500	2100
KTW0805UC033□GC	G、J、K	33	250MHz/0.5V	55	500	0.27	500	2050

All specifications are subject to change without notice.

KTW0805UC Series

Wire Wound Chip Inductors

Part Number	Accuracy grade	Inductance ^① (nH)	Inductance Test Conditions	Q value min.	Q value Test frequency (MHz)	DCR ^② (Ω)max.	Rated current ^③ (mA)	SRF(MHz) min.
KTW0805UC036□GC	G、J、K	36	250MHz/0.5V	55	500	0.28	500	2000
KTW0805UC039□GC	G、J、K	39	250MHz/0.5V	55	500	0.29	500	2000
KTW0805UC043□GC	G、J、K	43	250MHz/0.5V	50	500	0.30	500	1800
KTW0805UC047□GC	G、J、K	47	200MHz/0.5V	55	500	0.31	500	1650
KTW0805UC050□GC	G、J、K	50	200MHz/0.5V	55	500	0.34	500	1600
KTW0805UC051□GC	G、J、K	51	200MHz/0.5V	55	500	0.34	500	1600
KTW0805UC052□GC	G、J、K	52	200MHz/0.5V	55	500	0.34	500	1600
KTW0805UC053□GC	G、J、K	53	200MHz/0.5V	55	500	0.34	500	1600
KTW0805UC054□GC	G、J、K	54	200MHz/0.5V	55	500	0.34	500	1550
KTW0805UC056□GC	G、J、K	56	200MHz/0.5V	55	500	0.34	500	1550
KTW0805UC058□GC	G、J、K	58	200MHz/0.5V	55	500	0.38	500	1500
KTW0805UC060□GC	G、J、K	60	200MHz/0.5V	55	500	0.38	500	1500
KTW0805UC062□GC	G、J、K	62	200MHz/0.5V	55	500	0.38	500	1500
KTW0805UC068□GC	G、J、K	68	200MHz/0.5V	55	500	0.38	500	1450
KTW0805UC070□GC	G、J、K	70	200MHz/0.5V	55	500	0.38	500	1400
KTW0805UC072□GC	G、J、K	72	200MHz/0.5V	55	500	0.38	500	1400
KTW0805UC074□GC	G、J、K	74	200MHz/0.5V	55	500	0.40	400	1400
KTW0805UC075□GC	G、J、K	75	200MHz/0.5V	55	500	0.40	400	1400
KTW0805UC078□GC	G、J、K	78	200MHz/0.5V	55	500	0.42	400	1400
KTW0805UC080□GC	G、J、K	82	150MHz/0.5V	55	500	0.42	400	1300
KTW0805UC086□GC	G、J、K	86	150MHz/0.5V	55	500	0.45	400	1200
KTW0805UC091□GC	G、J、K	91	150MHz/0.5V	50	500	0.46	400	1100
KTW0805UC095□GC	G、J、K	95	150MHz/0.5V	50	500	0.46	400	1100
KTW0805UCR10□GC	G、J、K	100	150MHz/0.5V	50	500	0.46	400	1200
KTW0805UCR11□GC	G、J、K	110	150MHz/0.5V	45	250	0.51	400	1100
KTW0805UCR12□GC	G、J、K	120	150MHz/0.5V	45	250	0.51	400	1100
KTW0805UCR14□GC	G、J、K	140	150MHz/0.5V	45	250	0.56	400	950
KTW0805UCR15□GC	G、J、K	150	100MHz/0.5V	45	250	0.56	400	920
KTW0805UCR18□GC	G、J、K	180	100MHz/0.5V	45	250	0.64	400	870
KTW0805UCR20□GC	G、J、K	200	100MHz/0.5V	40	250	1.10	400	850

All specifications are subject to change without notice.

KTW0805UC Series

Wire Wound Chip Inductors

Part Number	Accuracy grade	Inductance① (nH)	Inductance Test Conditions	Q value min.	Q value Test frequency (MHz)	DCR ② (Ω)max.	Rated current ③ (mA)	SRF(MHz) min.
KTW0805UCR22□GC	G、J、K	220	100MHz/0.5V	40	250	1.05	400	850
KTW0805UCR23□GC	G、J、K	230	100MHz/0.5V	40	250	1.10	350	850
KTW0805UCR24□GC	G、J、K	240	100MHz/0.5V	40	250	1.10	350	850
KTW0805UCR25□GC	G、J、K	250	100MHz/0.5V	40	250	1.40	350	650
KTW0805UCR27□GC	G、J、K	270	100MHz/0.5V	40	250	1.10	350	650
KTW0805UCR29□GC	G、J、K	290	100MHz/0.5V	40	250	1.55	350	600
KTW0805UCR30□GC	G、J、K	300	100MHz/0.5V	40	250	1.55	350	600
KTW0805UCR33□GC	G、J、K	330	100MHz/0.5V	40	250	1.40	310	600
KTW0805UCR36□GC	G、J、K	360	100MHz/0.5V	40	250	1.50	290	560
KTW0805UCR39□GC	G、J、K	390	100MHz/0.5V	40	250	1.50	290	560
KTW0805UCR43□GC	J、K	430	100MHz/0.5V	33	100	2.00	260	420
KTW0805UCR47□GC	J、K	470	50MHz/0.5V	33	100	2.00	250	375
KTW0805UCR51□GC	J、K	510	25MHz/0.5V	30	100	3.20	150	530
KTW0805UCR56□GC	J、K	560	25MHz/0.5V	23	50	1.90	230	340
KTW0805UCR62□GC	J、K	620	25MHz/0.5V	23	50	2.08	200	320
KTW0805UCR68□GC	J、K	680	25MHz/0.5V	23	50	2.10	190	300
KTW0805UCR75□GC	J、K	750	25MHz/0.5V	23	50	2.12	180	280
KTW0805UCR82□GC	J、K	820	25MHz/0.5V	23	50	2.14	180	250
KTW0805UCR91□GC	J、K	910	25MHz/0.5V	20	50	2.28	180	220
KTW0805UC1R0□GC	J、K	1000	25MHz/0.5V	20	50	2.40	170	200
KTW0805UC1R2□GC	J、K	1200	7.9MHz/0.5V	18	50	2.55	170	180
KTW0805UC1R5□GC	J、K	1500	7.9MHz/0.5V	18	50	2.80	160	170
KTW0805UC1R8□GC	J、K	1800	7.9MHz/0.5V	18	50	3.80	150	140
KTW0805UC2R2□GC	J、K	2200	7.9MHz/0.5V	16	7.9	4.20	150	50

① Inductance tested using an Agilent/HP4286A or equivalent.

② DCR measured on a micro-ohmmeter.

③ Rated current: The DC current at which the temperature rise $\Delta t=40^{\circ}\text{C}$ ($T_a=20^{\circ}\text{C}$).

④ □ Represents the tolerance of inductance: G ($\pm 2\%$); J ($\pm 5\%$); K ($\pm 10\%$).

4. Packaging Quantity: 3000 pcs per Reel.

All specifications are subject to change without notice.